

JAMEC PEM

AIR HOSE REEL **LOCK OFF - RETRACTABLE - 20 M**



OPERATING INSTRUCTIONS
PRODUCT NO. 58.0201

AIR HOSE REEL LOCK OFF - RETRACTABLE - 20 M

With an incorporated lock off mechanism and layering system, the original Jamec Pem Hose Reel is ideally suited for the trade or industrial workshop where a lock mechanism is required for safety

FEATURES

- Hose layering system
- Auto lock / rewind
- Lock off mechanism
- Adjustable hose stop
- Wall mount with 180° pivot
- Weather resistant UV stabilised polypropylene case
- Leader hose 2 m with brass fittings

SPECIFICATIONS

Hose length	20 m
Hose I.D	10 mm (3/8")
Hose O.D	16 mm (5/8")
Leader hose length	2 m with 1/4" BSP Male fitting
Hose material	Reinforced PVC braided
Reel / case type	Retractable/Polypropylene
Auto lock / rewind	Yes
Max. working pressure	250 psi
Fitting size	1/4" BSP Male
Bracket	180° Pivoting
Weight - kg	9.7
Product dimensions	593 L x 262 W x 452.9 D mm
Advised application	Air

MAINTENANCE

- Always keep the hose clean. If the hose becomes dirty, clean it with a damp cloth while retracting.
- Mount the hose reel in a sheltered area to assist and protect the performance of the hose and reel.
- DO NOT allow the hose to contact any corrosive chemicals or fluids.
- Always retract the hose when not in use.
- This Jamec Pem Hose Reel contains a pre-tensioned spring inside the drum assembly.
- DO NOT attempt to open the drum assembly.
- If the hose jams, pull the hose fully out and retry. Repeat procedure if required.
- Always guide hose back into the reel and ensure the hose is clean and not twisted.



INSTALLATION

This Jamec Pem Hose Reel can be mounted in a horizontal or vertical position.

1. Choose a location that is near to the air source.
2. For large areas, place the hose reel at the centre of the work area.
3. When mounting the hose reel vertically, ensure there is adequate clearance under the reel to prevent injury or damage.

4. Install the mounting bracket onto a flat surface.

Note: It is recommended to install the mounting bracket 0.8m (minimum) above the floor level.

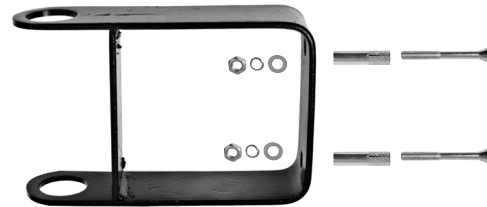

- a) Drill 2 x M8 holes to match the holes located in the mounting bracket.
- b) Push the 2 x M8 expansion bolts (supplied) into the holes and secure the mounting bracket using the washers and nuts.

5. Connect the hose reel to the mounting bracket with the metal tube.
6. Connect the inlet leader hose to the air source. Apply thread sealing tape to all air line and air fittings.



OPERATION

1. Slowly pull out the hose to the required length. A 'clicking' noise will be heard every revolution of the inner drum. To lock the reel, allow the hose to retract slowly after hearing the second or third 'click'.
2. To release the hose, pull out the hose until the 'clicking' noise stops, and then allow the hose to slowly retract.
3. TO LOCK THE HOSE – pull the hose out to the required length then move the latch lever on the side cover to the LOCK position. To release the hose, move the latch lever to the UNLOCK position and pull out the hose until the 'clicking' noise stops, and then allow the hose to slowly retract.

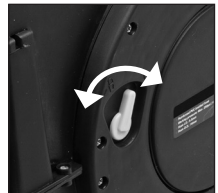

WARNING

To avoid injury and damage, always hold the hose while it is retracting.

WARRANTY

This Jamec Pem Hose Reel is covered against defects in material and workmanship for a period of 12 months from date of purchase.

The hose, o-rings and hose stopper are deemed normal wear items and are not warranted.

EXCLUSIONS

The warranty does not cover accident, misuse or faulty installation.

Irrespective of whether warranty is approved or rejected, the following costs are not covered under this warranty policy: fares, charter fares, car hire, freight, tolls, hire or loan equipment, loss of earnings or stock and medications.

To register a warranty claim visit: jamecpem.com

JAMEC PEM

Distributed by

TRADEPEM INDUSTRIAL PTY LTD.