

JAMEC PEM

WALL MOUNT TYRE INFLATOR **120° SWIVEL** **ACS5500**



OPERATING INSTRUCTIONS

PRODUCT NO.

11.0812 - Wall Mount Tyre Inflator - ACS5500

**UK
CA**



**COMPLIES WITH
EN12645: 2014***

jamecpem.com

TYRE INFLATOR 120° SWIVEL - ACS5500





FEATURES

- 120° swivel main body to highly optimise the user angle of view
- Supplied with calibration certificate
- Accuracy exceeds EN12645:2014 Standards
- Includes ceramic sensor
- Durable ABS case with mechanical anti-vandal buttons
- Large VA LCD screen with white font
- Suitable for indoor & outdoor
- Audible warning once pressure is reached
- Bluetooth® / Wi-Fi connection, controlled with app (iOS & Android)
- Comprehensive diagnostics and error reporting
- OPS (Over Pressure Setting) function that allows the tyre to be inflated to a certain pressure then deflates automatically to a normal operating pressure, used for seating tyres on rims
- IP 44 rated

SPECIFICATIONS	
Part No.	11.0812
Operation	Inflate / deflate / measure
Max. inlet pressure	182 psi / 12.5 bar / 1250 kPa / 12.5 kgf
Measuring range	7 – 174 psi / 0.5 – 12 bar / 50 – 1200 kPa / 0.5 – 12 kgf
Display increments	± 0.1 psi / 0.01 bar / 1 kPa / 0.01 kgf
Chuck type	Clip on
Chuck style	Single straight
Scale	psi, bar, kPa, kgf
Inlet size	1/4" BSP
Hose length	7.6 m / 25'
Accuracy	± 1 psi @ 25 – 75 psi
Power source	240 V
IP rating	IP 44
Advised application	Industrial, mechanical workshops, forecourts, tyre stores

CONTROL PANEL

SWITCH FUNCTION:

-  Reduce final target pressure
-  Increase final target pressure
-  **Function select:** Change unit, set OPS
-  **Function select:**
Confirm / Start inflation / Stop inflation
Press to start the inflation process when the tyre pressure is less than 3 psi / 0.2 bar / 20 kPa / 0.2 kgf

LCD DISPLAY

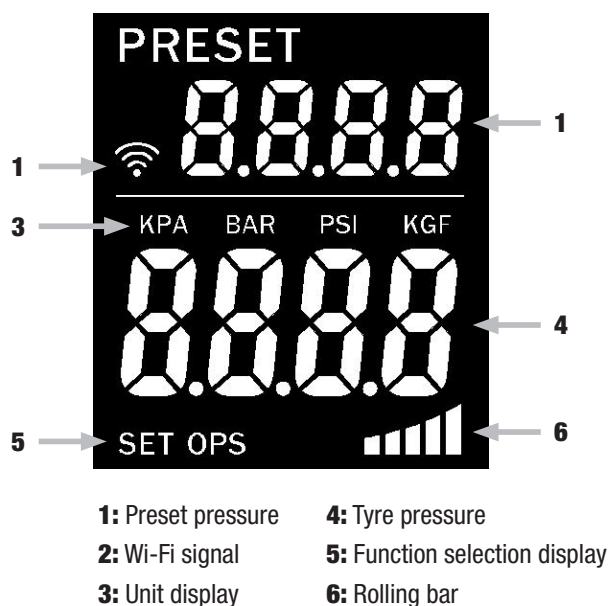

REMOTE

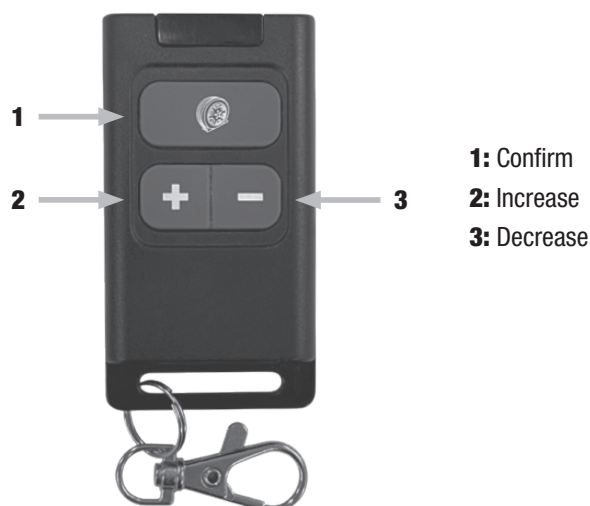

IMPORTANT

This tyre inflator must only be connected to air line systems which have clean dry air. Any moisture in the air line system may cause damage to the operation of this tyre inflator and void warranty. Air pre-filters must be used with this inflator to ensure product accuracy and longevity.

SAFETY

Never exceed the maximum pressure of the tyre. Check that the hose and chuck are in good condition with no damage or cracks. Ensure safe working environment when using compressed air. Return to authorised service agent for repair and maintenance.

WARNING

To avoid risk of personal injury, especially to the eyes, face and skin **DO NOT** direct the air stream at any person, or any part of the body. This equipment is not intended for use by children without adult supervision. The manufacturer reserves the right to change product features at any time without notice.

INSTALLATION

- 1: Unpack the unit.
- 2: Hold the unit up to the wall where the 4 holes are to be drilled.
- 3: Secure the unit to the wall using suitable fasteners.
- 4: Connect the air supply to the unit.
- 5: Connect the air hose to the air outlet.
- 6: Connect the power supply. Refer to the rating label for the correct power requirements.

IMPORTANT:

Prior to installation check carefully to ensure no part is damaged, for safe and normal operation.

The inflator can be installed outside however shelter is recommended to protect the equipment from weather, extending the service life.

The inflator should be installed by a qualified professional.

OPERATION

SELECT UNIT:

The tyre inflator has four units that can be chosen: psi, bar, kPa, kgf. The unit set will become the default unit for following usage. It does not need to be set each time.

- 1: Press **i**, **SET** will be shown on the LCD screen. The unit will flash.
- 2: Press **+** or **-** to select the unit.
- 3: Press  to confirm.

SET OPS (OVER PRESSURE SETTING):

- 1: Press **i** twice, **SET** and **OPS** will be shown on the LCD screen, **OPS** will flash.
- 2: Press **+** or **-** to select the OPS value.
- 3: Press  to confirm. If OPS value is not zero, **OPS** will be displayed on the screen.

NOTE:

When the OPS function is active, the inflator will inflate to the target pressure plus the OPS value first, then deflate to the target pressure.

For example: If a final target pressure of 32 psi and OPS of 16 psi is set, the inflator will inflate to 48 psi (32 psi + 16 psi) then deflate back to 32 psi.

INFLATION AND DEFLATION:

- 1: Press **+** or **-** to select the target tyre pressure.
- 2: Connect the air hose to tyre and ensure there are no leaks. The inflator will begin automatically.
- 3: When inflation / deflation is complete, the inflator will stop automatically and beep to confirm.
- 4: Disconnect the air hose from the tyre.

USING THE REMOTE:

- 1: Press **+** or **-** to select the target tyre pressure.
- 2: Press  to confirm target tyre pressure.

NOTE:

If the tyre pressure is lower than 3 psi / 0.2 bar / 20 kPa / 0.2 kgf, the inflator will not begin automatically. Press  for 2 seconds to start inflation.

During inflation, the inflator will check the tyre pressure automatically. The rolling bar will indicate inflation / deflation: Rolling left to right: Inflating. Rolling right to left: Deflating.

IMPORTANT:

Do not exceed maximum air inlet pressure of 182 psi / 12.5 bar / 1250 kPa / 12.5 kgf

FUNCTION SETTINGS:

- 1: Press **i** to enter the function setting mode.
- 2: After selecting the unit, press **i** again to enter the **OPS** setting mode.
- 3: Press **i** a third time to exit the function settings without saving any selection.

WI-FI / BLUETOOTH® CONNECTION

DOWNLOAD SMART LIFE APP:

Scan the QR code below to download the Smart Life App.

The Smart Life app can be found in the App Store and Google Play.



ADD DEVICE:

- 1: Power on the device.
- 2: Open the app. Tap 'Add' to add devices.

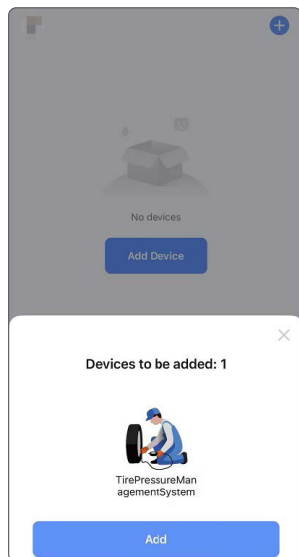

- 3: Enable location permission.

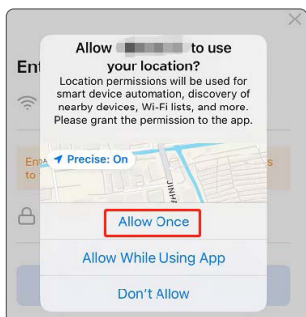
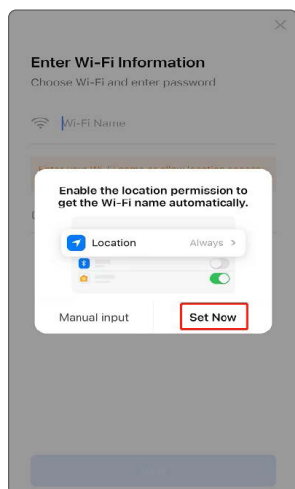

- 4: Enter the Wi-Fi information. Tap 'Next' to begin connecting.

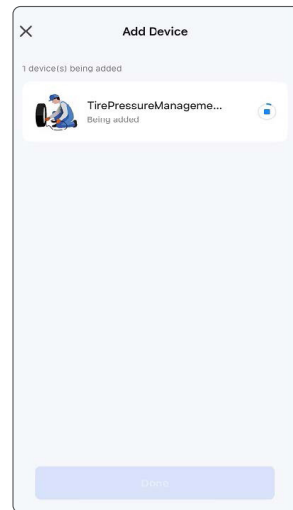
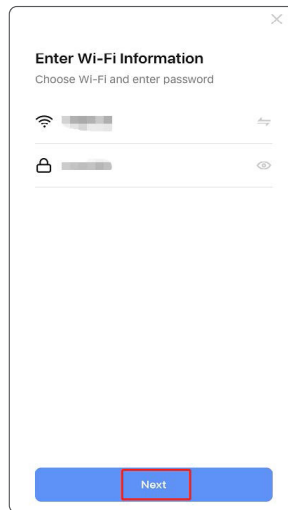

- 5: Tap 'Done' when finished connecting.



CONTROLLING THE INFLATOR:

1: Enter the operation interface. You can use your phone to set the target pressure value.

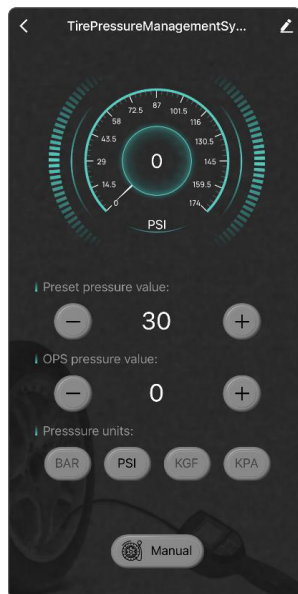

2: When the chuck is connected to the tyre valve, the tyre inflator will automatically begin. The app will switch to the working mode.

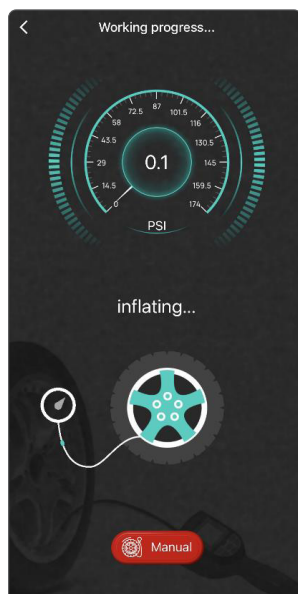

3: Once inflating and deflating is completed, the tyre inflator will beep to indicate completion. The app will switch to the completion interface.

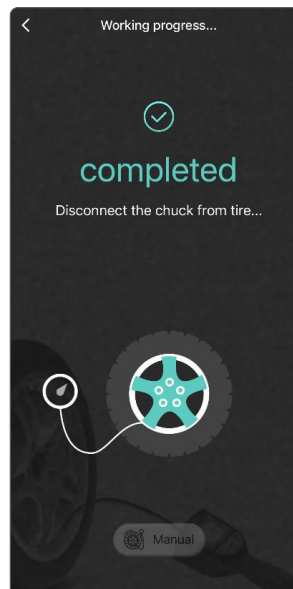

TROUBLESHOOTING

PROBLEM	POSSIBLE CAUSE	SOLUTION
Air leak	Leak in the connection	Check the pneumatic connection
The inflator works, but no air is inflated	Obstruction in filters or air system	Clean the filters and check the air tube
No display	Check power supply	Reconnect power supply
Inflation does not start, however the pressure is set and the hose is connected to the tyre	Air hose improperly connected	Check the hose connection and ensure there are not air leaks
	Tyre pressure is below 3 psi / 0.2 bar / 20 kPa / 0.2 kgf	Press 
The unit deflates very slowly	The silencer plug is blocked	Remove and clean the silencer plug
Er1	Pressure sensor is broken	Turn power off and change the pressure sensor
Er2	Unstable pressure, faulty hose connector	Replace hose connector or reconnect hose to the tyre
Er3	Connected tyre pressure is too high (>188.5 psi / 13 bar / 1300 kPa / 13.25 kgf)	Stop inflating tyre
Er4	Wrong connections at air inlet and outlet	Refer to wiring diagram and connect magnetic valve accordingly
Er5	Low voltage	Check power supply
Er6	Calibration error	Unit requires calibration
Er7	Calibration error	Unit requires calibration
Er8	Air supply lower than set inflate pressure	Stop inflating tyre

MAINTENANCE

The device does not require particular maintenance. Routine check of the pneumatic connection is suggested. All maintenance should be completed by a qualified professional.

WARRANTY

The Tyre Inflator - ACS5500 has a 1 year warranty from the date of invoice. Products that have been damaged by misuse, faulty installation, incorrect maintenance, accidental damage, unauthorized modification or repair, and/or force majeure are not covered by warranty.

Warranty does not cover air hoses or hose connectors (hose chucks).

All faulty PCBs that are within the warranty period are to be returned for assessment and repair. PCBs that are found to be burnt due to water damage are not covered by warranty.

NOTES

[illegible]

JAMEC PEM

JAMEC PEM

Distributed by
TRADEPEM INDUSTRIAL PTY LTD.

jamecpem.com